

Sustainable cities: Mixed use in districts with the **Green Tower**



The future of urban construction: **Green Tower**

The green tower is a building which allows for a mixed use and fast construction time. Moreover, with timber as the main building material the building will live up to its reputation as green tower:

- A timber frame building reduces the total CO₂ emissions by 40% compared to a building made of reinforced concrete²⁾
- Units of the building (apartments, offices, ...) are prefabricated modules, which can be changed if needed
- Fast construction (6 months) = faster revenues
- This building is a product, not a prototype - due to prefabricated elements

²⁾ Klippel et al., "Life cycle assessment of a post-tensioned timber frame building in comparison to a reinforced concrete frame for tall buildings", SBE conference Zurich, 2016

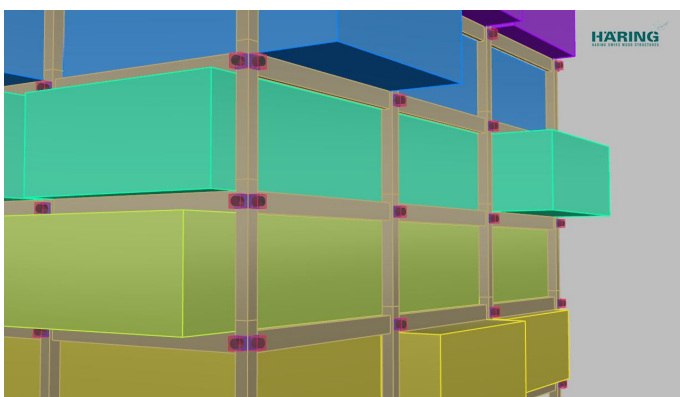

Units of the building are prefabricated modules that can put in place like drawers. Different colours indicate a different use.

Urban population growth

Cities have been growing in the past. This trend will continue, leading to a growth of population in the cities. The WHO estimates that by 2017 a majority of people will be living in urban areas¹⁾.

Growing cities are confronted with several problems, including increased traffic due to people that have to commute.

In order to reduce commuting, town districts need to offer office spaces, recreational facilities and shopping opportunities next to accommodations. A mixed use helps to avoid unnecessary travelling in the city: **Walk more, drive less!**

¹⁾ Urban population growth, Global Health Observatory data, www.who.int

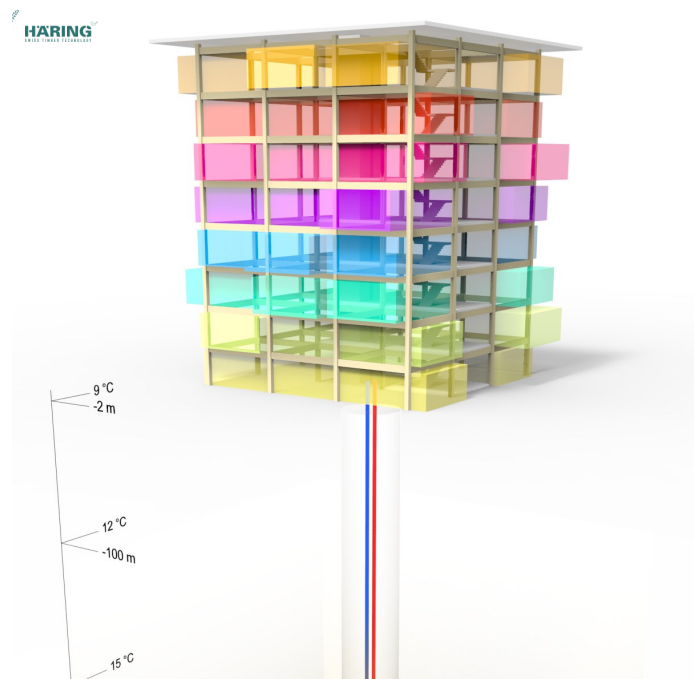

The **Green Tower** is designed with a timber frame and heated with a geothermal probe heat pump; ecological during construction and utilisation!

Want to know more? Contact us:

Flavio Wanninger
Swiss Timber Solutions
IBK, Stefano-Frascini-Platz 5
8093 Zürich

wanninger@swisstimbersolutions.ch
www.swisstimbersolutions.ch